

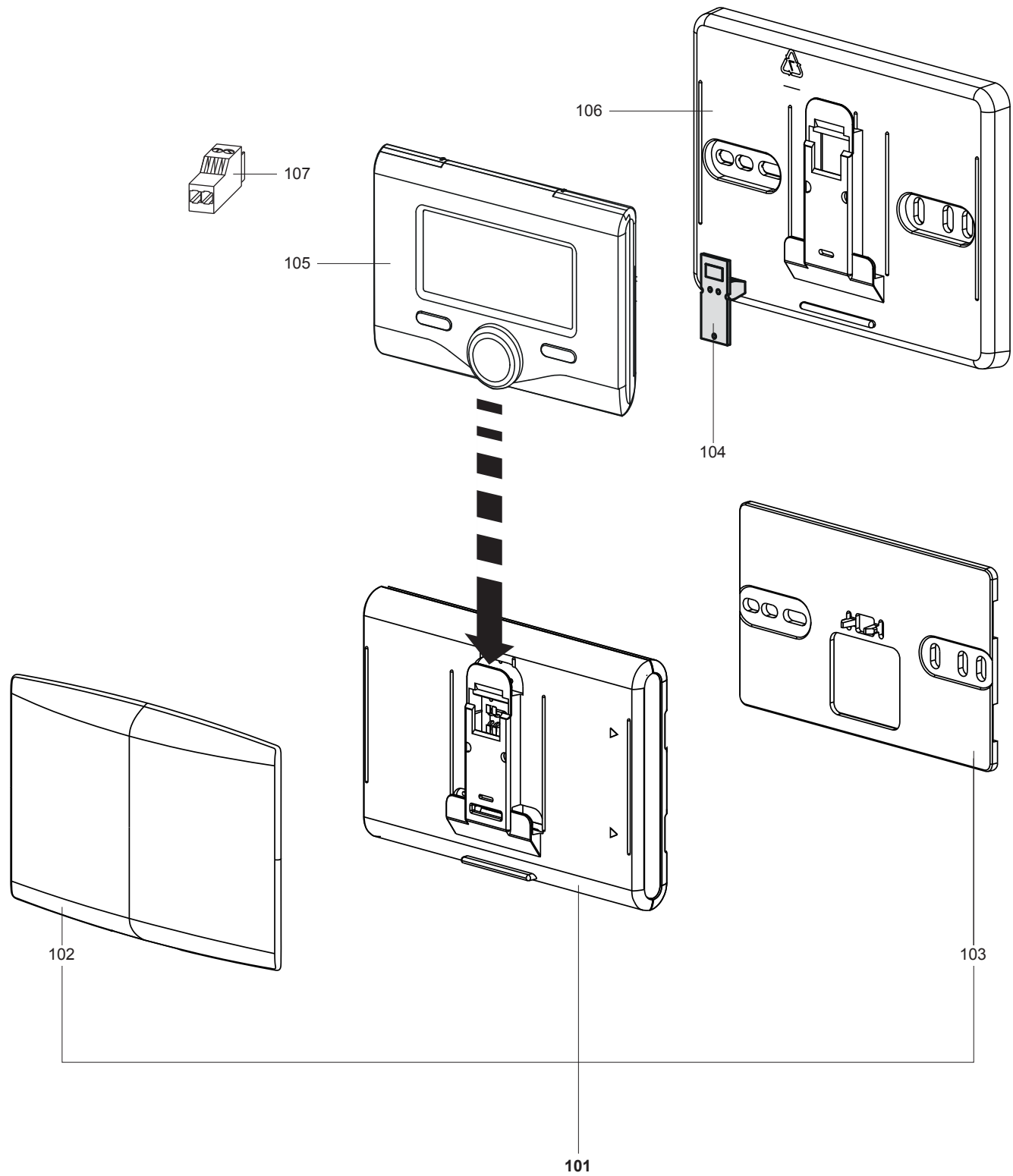

SPARE PARTS EXPLODED VIEW
ACCESSORIES FOR CONTROLLERS
Model
LIGHT GATEWAY

R8217582-02 - 30/01/2018

1	3319089	ARISTON NET LIGHT GATEWAY	10-2016	-
2	3319090	CHAFFOLINK LIGHT GATEWAY	10-2016	-
3	3318991	ARISTON NET LIGHT GATEWAY + SENSYS	07-2016	-
4	3318992	CHAFFOLINK LIGHT GATEWAY +EXPERT CONTROL	07-2016	-
5	3319034	ARISTON NET LIGHT GATEWAY + SENSYS (CN)	07-2016	-
Col	Reference	Model type	Begin	End

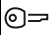

Description	Manf. Pt. N	Type	<div style="border: 1px solid black; padding: 2px;">  31 </div>																		From	to		
			1	2	3	4	5	6	7	8	9	10	11	12	13	14	15	16	17	18				
0101	ARISTON NET LIGHT GATEWAY	3319089-SP		•																				
	CHAFFOLINK LIGHT GATEWAY	3319090-SP			•																			
	CHAFFOLINK LIGHT GATEWAY+EXPERT CONTR	3319034-SP							•															
0102	COVER (AR)	65116083		•																				
	COVER (CM)	65116086			•																			
0103	WALL PLATE	65116082		•	•	•	•	•																
0104	P.C.B. CONNECTOR	65112042				•	•	•																
0105	SYSTEM INTERFACE	65112083-05					•	•																
	SYSTEM INTERFACE	65116085-01																						
0106	WALL PLATE	65112824					•	•	•															
0107	CONNECTOR 2P	65111933					•	•	•															

LIGHT GATEWAY

Accessories for controllers

LIST OF THE ABBREVIATIONS

HW	: Hot water.
CW	: Cold water.
C	: Ceramic resistance (normal heating).
Ca	: Ceramic resistance (accelerated heating)
TP	: Immersion heater.
1F	: With fittings.
2F	: Without fittings.
3F	: With fittings and another outlet connection.
AMI	: With mixing valve.
SMI	: Without mixing valve.
PUISS	: Power of th appliance.
PN	: Appliance with normal pression.
LP	: Appliance with low pression.
PV	: Appliance with variable power.
PF	: Appliance with fixed power.

The indications mentioned on the prices, commercial or technical literature and the scheme are written for your guidance and are available at a given time. The CONSTRUCTOR retains the power to modify the presentation, the form, the size, or the conception or the material of the products.
